

Courses	Dist.
S 70 E	39 White Oak
S 20 W	92 White Oak
S 50 E	30 Beech
S 45 W	40 White Oak
S 15 E	46 Chestnut oak
S 55 W	30 Pine
West	104 Hickry
N 7 E	50 White oak
N 26 E	76 White Oak
N 40°40' E	119 Post

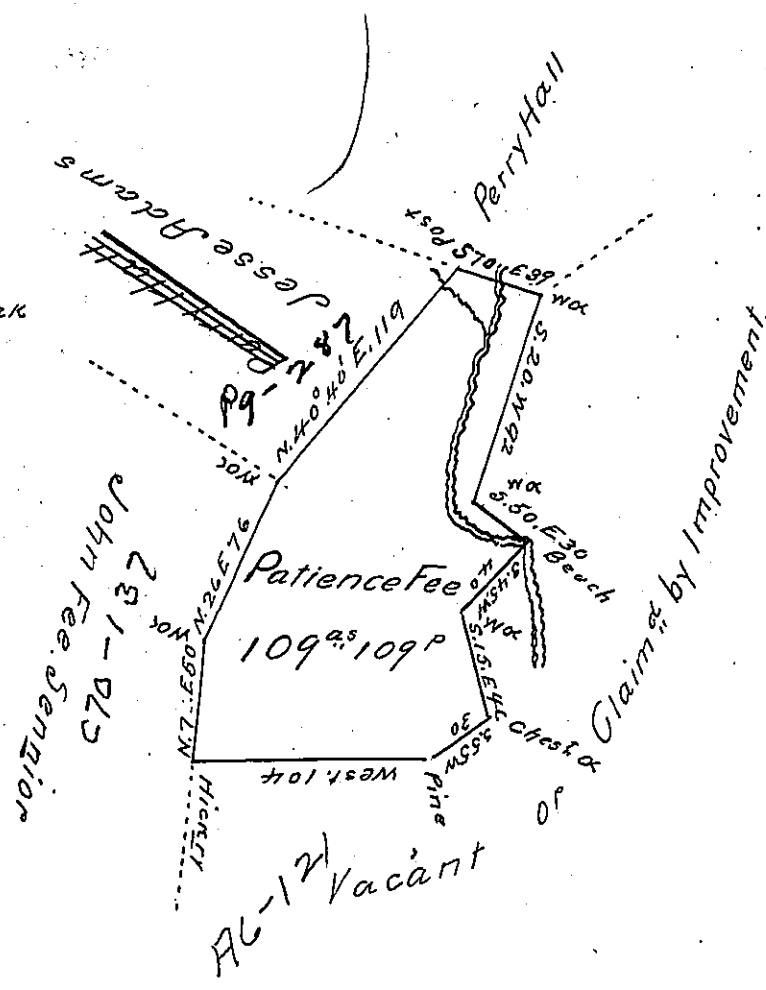

Situate in Huntingdon County and Township joining Lands of John Fee Sen^r Perry Hall and others Containing one Hundred and Nine acres and a Hundred and Nine Perches and allowance of Six P^r Q^t for Roads Survey'd the 10th day of October 1794 in Pursuance of a Warrant to Patience Fee Dated the Eighteenth Day of March 1786

John Canan D.S.

To Daniel Broadhead Esqr. S.G.

IN TESTIMONY that the above is a copy of the original remaining on file in the Department of Internal Affairs of Pennsylvania, made conformably to an Act of Assembly approved the 16th day of February, 1833, I have hereunto set my Hand and caused the Seal of said Department to be affixed at Harrisburg, this nineteenth day of September 1904

James D. Brown
Secretary of Internal Affairs.